

Product Descriptions

WiFi Ceiling Fan Remote Controller

Model #: uCF281

(Please visit our website www.a-brt.com for more info)



Features:

uCF281 is a ceiling fan remote controller which has a WiFi module built-in so that the ceiling fan can be remotely controlled by a smart phone.

- Good for all ceiling fans;
- Two load outputs, one for controlling the fan and another one for controlling the lights;
- Three fan speeds;
- Precise timer function;
- Bidirectional communication enabling status display of fans, lights, and timer;
- Rectangular shape which can easily fit into the canopy of ceiling fans;
- ABS-V0 flame resistance material; and
- Elegant design and high quality build.

What Are Included?

uCF281 WiFi ceiling fan remote controller kit consists of a rectangular shaped receiver and a smart phone APP, as shown in Fig. 1



Fig. 1 uCF281 WiFi Ceiling Fan Remote Controller Kit

- A rectangular receiver that can receive control commands from a smart phone. This receiver uses existing wiring and can easily fit into the canopy of ceiling fans; and
- An APP to be loaded into a smart phone. This APP will turn a smart phone into a remote control device with friendly user interface.

Specification Parameters:

Input Voltage	220~240V(50Hz/60Hz)	Operation Environment	No-condensation 20-90% RH, -20℃~40℃
Fan Wattage	150W	Light Wattage	600W
Receiver Dimension	120mm x 53mm x 25mm	Receiver Weight	115g

Wiring Diagram and Installation Guide:

The controller has its all connection wires clearly labelled, as shown in Fig. 2.

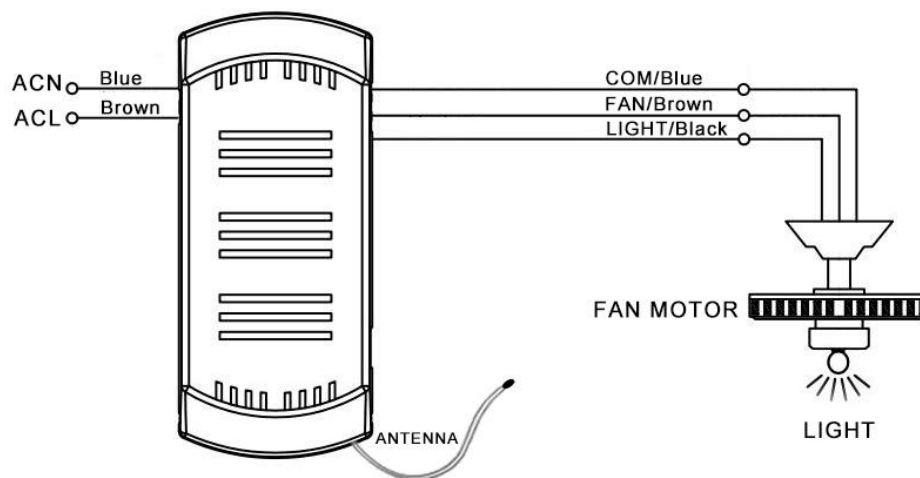

Fig. 2 uCF281 controller Wiring Diagram

- AC-L: Connected to the hot wire of power supply
- AC-N: Connected to the neutral wire of power supply
- Light: Connected to the lights
- Motor: Connected to the fan
- COM: Connected to the neutral wire of the fan and/or lights

Warning: Please make sure power is turned off before starting installation!

Once properly wired, the uCF281 controller can be installed into the canopy of a ceiling fan, as shown in Fig. 3.

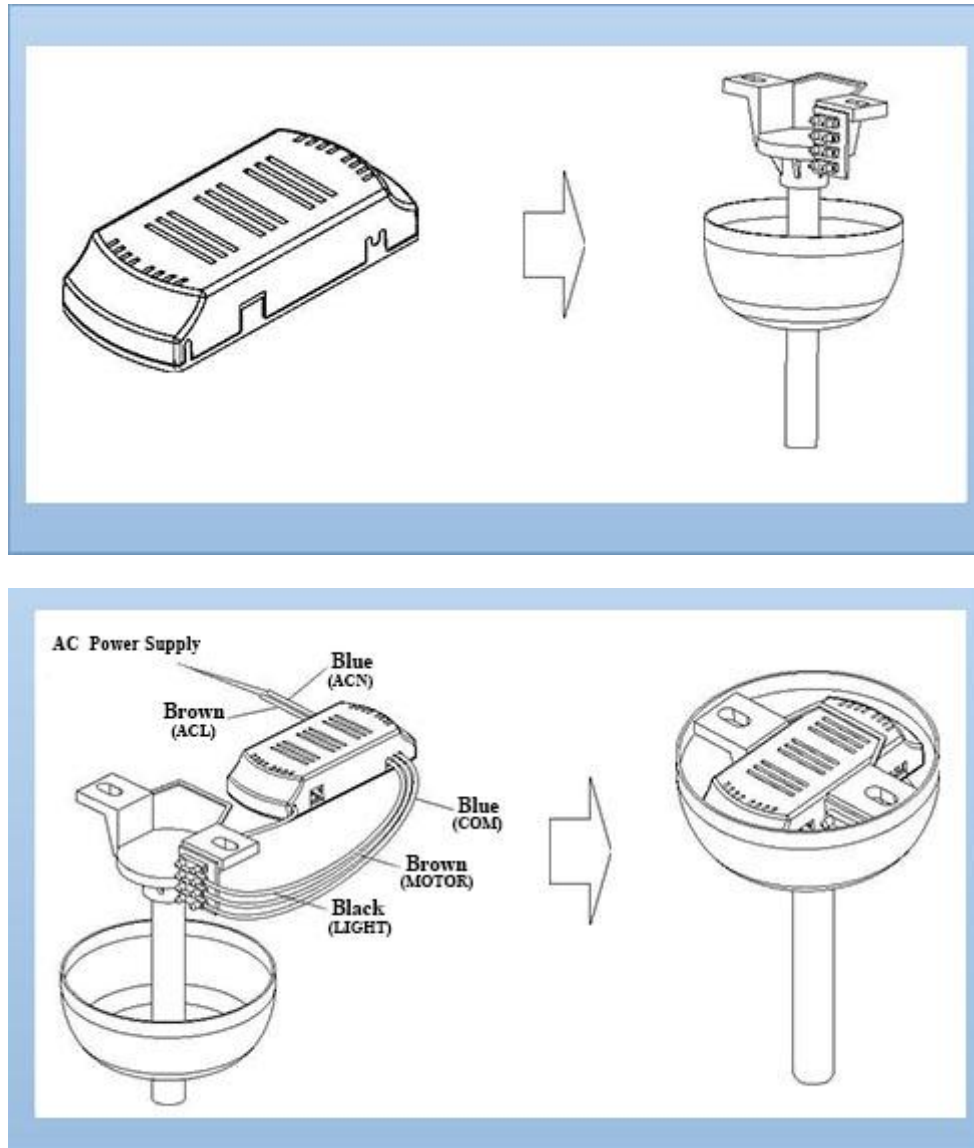

Fig. 3 uCF281 controller Installation

Setup and Operation Guide:

First, please turn on the power supply to the ceiling fan and lights. If there is another switch to control the fan speed and the lights, please set the switch to the highest fan speed and turn on the

lights. Follow the instruction comes with the ceiling fan remote controller to download a smart phone APP from the designated website. The steps of setting up the APP are as follows:

- 1.1 Turn on the power to the ceiling fan. Load the APP into smart phone and launch the APP;



- 1.2 Click “Add Device” button, enter Device ID and Password. Every controller has a unique ID assigned at factory, and the default Password is 1234567. The password can be changed by the user once the initial setup and operation are completed.



1.3 Press “Confirm” button to link the ceiling fan. If the setup is successful, the status will show “Device Online”. In case “Device Online” is not shown, press the Refresh button (a circle with an arrow at the top-right-corner). Once “Device Online” is confirmed, the ceiling fan and lights are ready to be directly controlled by the smart phone in an interface as follows:

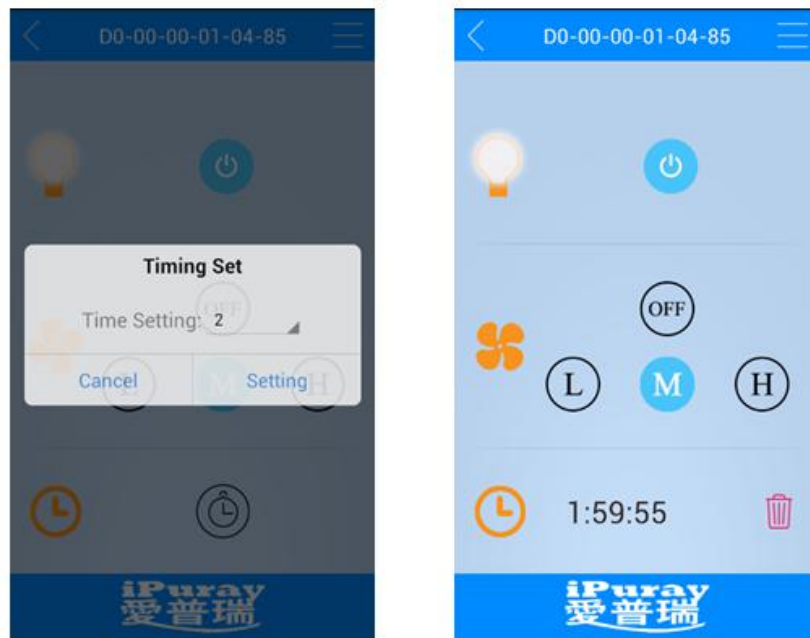

The control buttons are self-explanatory. They are used for turning on or tuning off lights, turning on ceiling fan at low, medium, or high speed or turning off ceiling fan, and setting up timer.

1.4 The ceiling fan can also be controlled by a smart phone via Internet. The fan needs to be linked to a router first.

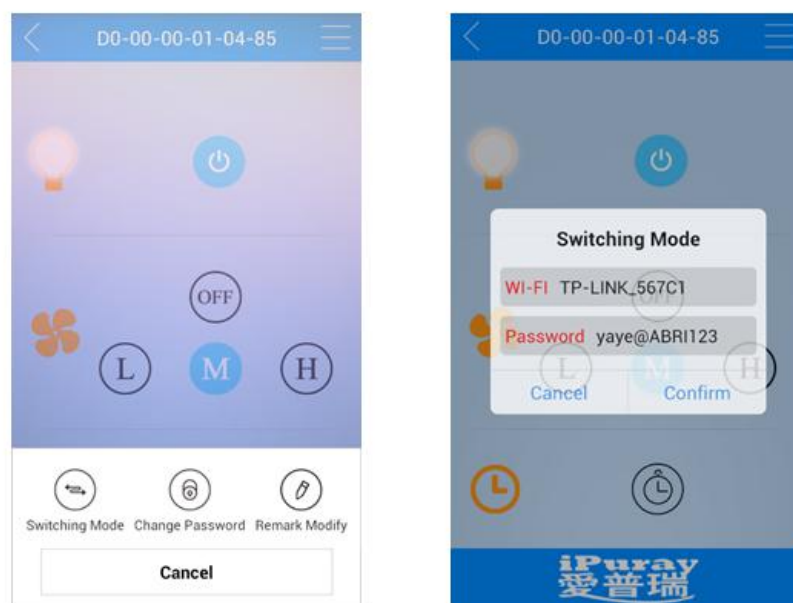

Press the Menu button (3 horizontal bars at the top-right-corner) to bring up a setup menu. Press “Switching Mode” button to bring up the router setup window. Enter the name of your router and Password of your router. Press “Confirm” button to link to the ceiling fan.

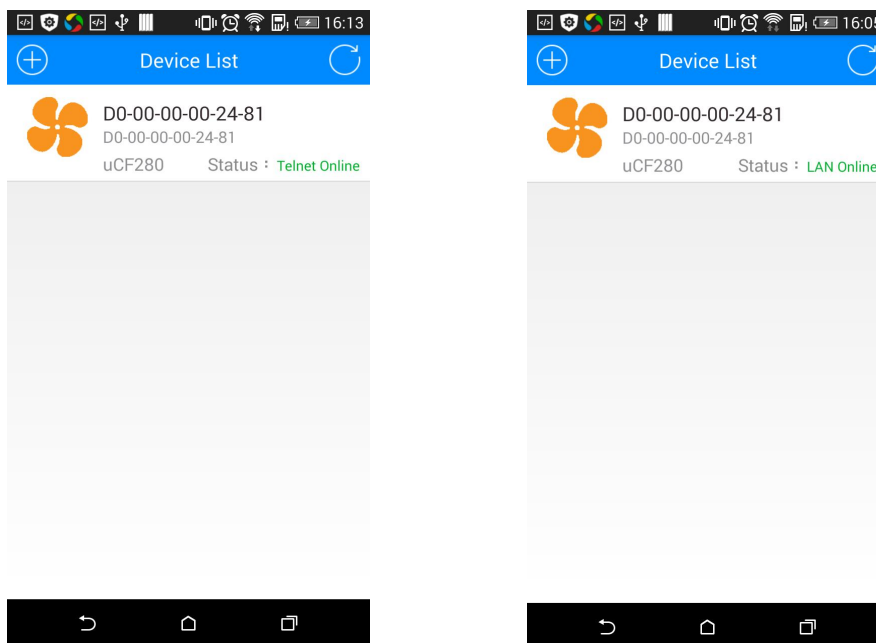

Pressing the Refresh button (a circle with an arrow at the top-right-corner) will update the status. If the status shows “Telnet Online” or “LAN Online”, the fan has been successfully linked to the router. When the router is connected to the internet, the status will show “Telnet Online” and the fan can be controlled anywhere as long as internet access is available. When the router is not connected to the internet, the status will show “LAN Online” and the fan can only be controlled within the coverage range of the router.

1.5 Password Change: Press the Menu button (3 horizontal bars at the top-right-corner) to gain access to the setup menu, and then press “Change Password” button to bring up a window for password change.

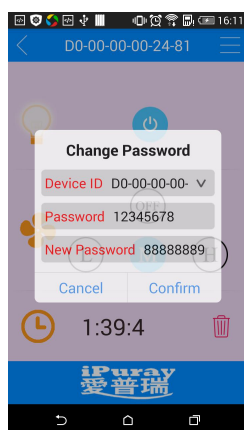

1.6 There is a reset button on the side of uCF281 ceiling fan remote controller, as shown in Fig. 4. Pressing this button for 5 seconds will restore all the settings to the default factory values.



Fig. 4 Reset Button of uCF281 controller

Applications:

uCF281 WiFi ceiling fan remote controller are good for all kind of ceiling fans, even for retrofitting an older ceiling fan. It can bring convenience and ease to our daily life and work.

They have wide applications at various locations such as homes, restaurants, conference rooms, theaters, etc.

How to Order:

Please contact us: Shenzhen Asia Bright Co., Ltd
Floor 2nd~3rd, Building E, North Area No.2 of Shangxue
Science Park, Bantian, Shenzhen, China
Tel: +86-755-89748200 +86-755-89748211
Email: sales@a-brt.com Website: www.a-brt.com