

Product Descriptions

WiFi/RF Ceiling Fan Remote Control Kit

Model #: uCF691

(Please visit our website www.a-brt.com for more info)



Features:

uCF691 is the smartest ceiling fan remote control kit. In addition to traditional RF 433MHz remote control, its receiver has a WiFi built-in module so that the ceiling fan can also be remotely controlled by a smart phone.

- Good for all ceiling fans;
- Two load outputs, one for controlling the fan and another one for controlling the lights;
- Three fan speeds;
- Precise timer function(on phone operation);
- ABS-V0 flame resistance material; and
- Elegant design and high quality build.

What Are Included?

uCF691 WiFi/RF ceiling fan remote control kit consists of three pieces, as shown in Fig. 1



Fig. 1 uCF691 WiFi/RF Ceiling Fan Remote Control Kit

Product Description of uCF691

Shenzhen Asia Bright Co., Ltd.

Floor 2nd~3rd, Building E, North Area No.2 of Shangxue Science Park, Bantian, Shenzhen, China

www.a-brt.com. sales@a-brt.com.

© 2022 All rights reserved. Subject to change without notices.

- An RF 433MHz remote control unit which either can be hanged onto a wall mount base like a standard wall mount switch, or can be detached from the wall mount base as a handheld device. Fig. 2 shows the phone interface for the uCF691 receiver,
- A rectangular receiver that can receive control commands either from the remote control unit or a smart phone. This receiver uses existing wiring and can easily fit into the canopy of the ceiling fans; and
- An App to be loaded into a smart phone. This App will turn a smart phone into a remote control device with friendly user interface.

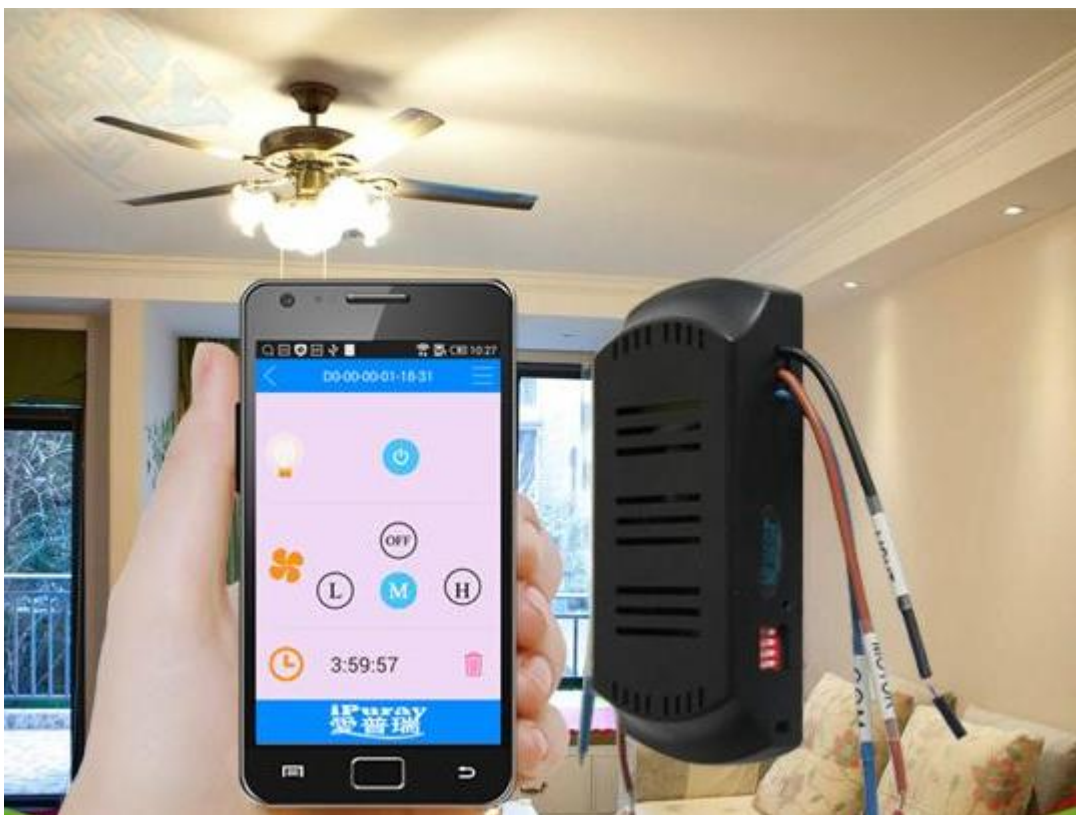

Fig. 2 The Fan Control Interface

Remote Control Unit:

Fig. 3 shows the front view, back view and wall plate of uCF691 remote control unit, respectively. The remote control unit has four buttons on the front, and has structural features on its back for easy attachment to a wall mount base (not shown here).



Fig. 3 uCF691 Remote Control Unit

The 4 buttons on the front have the following functions:

- 1. Turn on fan:** The remote control unit has three buttons LOW, MED, and HI. Pressing each of these three buttons will turn on the fan and set the fan to low speed, medium speed and high speed respectively.
- 2. Turn off fan:** Long pressing either of the LOW/MED/HI button will turn off the fan.
- 3. Turn on or turn off light:** Pressing the LIGHT button will turn on or turn off the lights.

Specification Parameters:

Input Voltage	220~240V(50Hz/60Hz)	Operation Environment	No-condensation 20-90% RH, -20℃~40℃
Fan Wattage	150W	Light Wattage	600W
Battery for Remote Control	AAA batteries	Working Distance of Remote Control	>= 10m
Remote Control Dimension	120mmx74mm	Receiver Dimension	120mm x 53mm x 23mm

Wiring Diagram and Installation Guide:

uCF691 remote control unit is battery driven and there is no wiring requirement. The receiver has its all connection wires clearly labeled, as shown in Fig. 4.

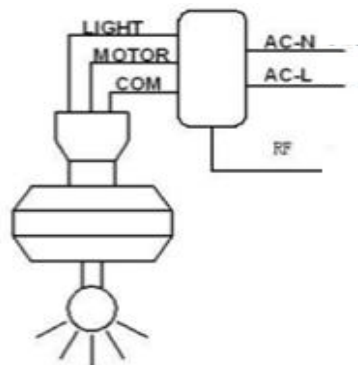

Fig. 4 uCF691 Receiver Wiring Diagram

- AC-L: Connected to the hot wire of power supply
- AC-N: Connected to the neutral wire of power supply
- Light: Connected to the lights
- Motor: Connected to the fan
- COM: Connected to the neutral wire of the fan and/or lights
- RF: Antenna, no connection

Warning: *Please make sure power is turned off before starting installation!*

Once properly wired, the uCF691 receiver can be installed into the canopy of the ceiling fan, as shown in Fig. 5.

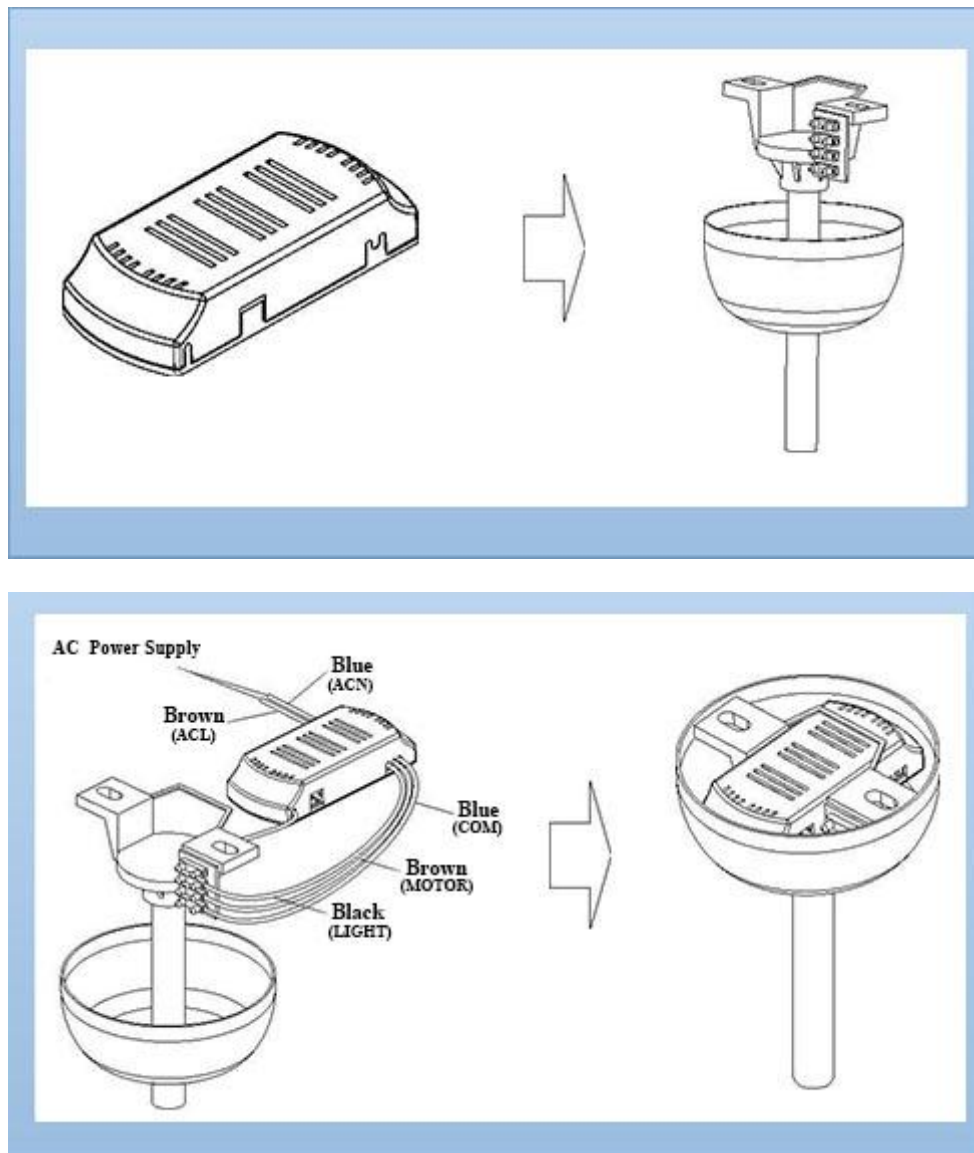

Fig. 5 uCF691 Receiver Installation

Setup and Operation Guide:

1. Setup and Operation of uCF691 Remote Control Unit:

There is a dip switch on the back of uCF691 remote control unit and there is a dip switch on the side of uCF691 receiver. Set these two dip switches to identical positions. The remote control unit will be able to send commands to the receiver and read the status from the receiver.

1.1 Change fan speed: Pressing the fan speed control button will turn on or turn off the fan. When the fan is on, pressing the speed button “HI/MED/LOW”, the fan speed will be changed into high speed, middle speed and low speed respectively.

1.2 Turn on or turn off the light: Pressing the light control button will turn on or turn off the lights.

2. Setup and Operation of Smart Phone:

Please follow the instruction comes with the ceiling fan remote control kit to download a smart phone App from the designated website. The steps of setting up the App are as follows:

2.1 Turn on the power to the ceiling fan. Load the App into smart phone and launch the App;



2.2 Click “Add Device” button, enter Device ID and Password. Every receiver has a unique ID assigned at factory, and the default Password is 12345678. The password can be changed by the user once the initial setup and operation are completed.



- 2.3 Press “Confirm” button to link the ceiling fan. If the setup is successful, the status will show “Device Online”. In case “Device Online” is not shown, press the Refresh button (a circle with an arrow at the top-right-corner). Once “Device Online” is confirmed, the ceiling fan and lights are ready to be directly controlled by the smart phone in an interface as follows:

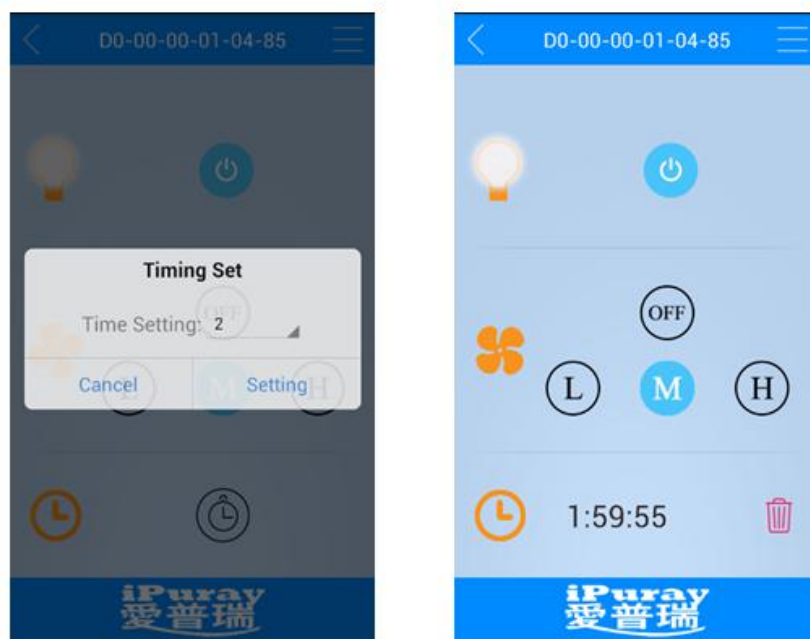

- 2.4 The ceiling fan can also be controlled by a smart phone via Internet. The fan needs to be linked to a router first.

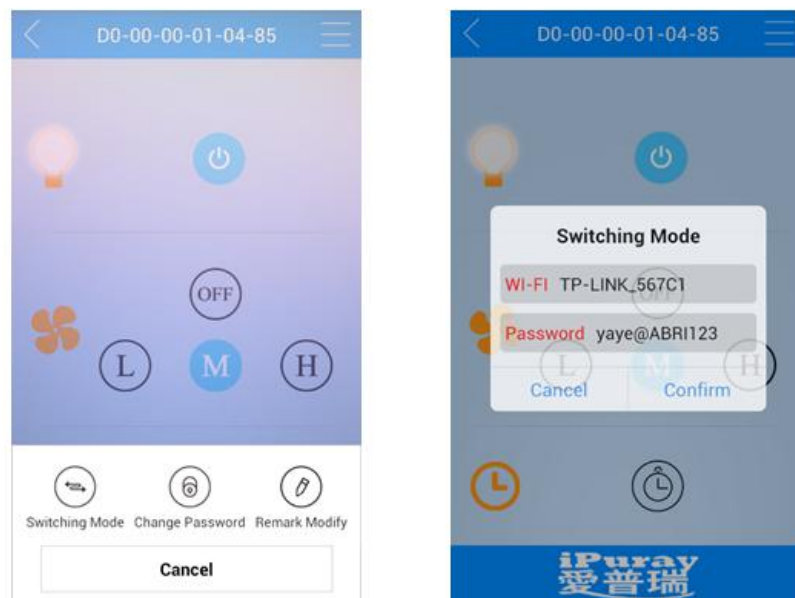

Press the Menu button (3 horizontal bars at the top-right-corner) to bring up a setup menu. Press “Switching Mode” button to bring up the router setup window. Enter the name of your router and password of your router. Press “Confirm” button to link to the ceiling fan.

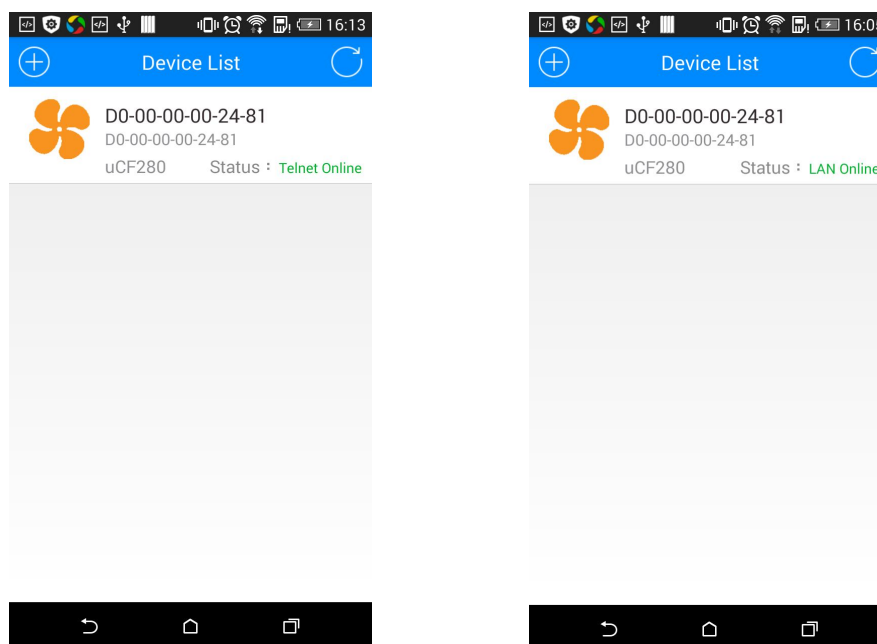

Pressing the Refresh button (a circle with an arrow at the top-right-corner) will update the status. If the status shows “Telnet Online” or “LAN Online”, the fan has been successfully linked to the router. When the router is connected to the internet, the status will show “Telnet Online” and the fan can be controlled anywhere as long as internet access is available. When the router is not connected to the internet, the status will show “LAN Online” and the fan can only be controlled within the coverage range of the router.

2.5 Password Change: Press the Menu button (3 horizontal bars at the top-right-corner) to gain access to the setup menu, and then press “Change Password” button to bring up a window for password change.

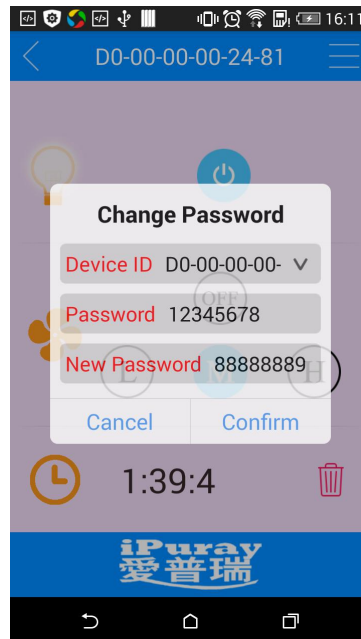

Applications:

uCF691 WiFi/RF ceiling fan remote control kit are good for all kind of ceiling fans, even for retrofitting an older ceiling fan. It can bring convenience and ease to our daily life and work.

They have wide applications at various locations such as homes, restaurants, conference rooms, theaters, etc.

How to Order:

Please contact us: Shenzhen Asia Bright Co., Ltd
Floor 2nd~3rd, Building E, North Area No.2 of Shangxue
Science Park, Bantian, Shenzhen, China
Tel: +86-755-89748200 +86-755-89748211
Email: sales@a-brt.com Website: www.a-brt.com

Product Description of uCF691

Shenzhen Asia Bright Co., Ltd.
Floor 2nd~3rd, Building E, North Area No.2 of Shangxue Science Park, Bantian, Shenzhen, China
www.a-brt.com. sales@a-brt.com.

© 2022 All rights reserved. Subject to change without notices.