

Product Descriptions

RF Ceiling Fan Remote Control Kit

Model #: AS-CF691

(Please visit our website www.a-brt.com for more info)



Features:

AS-CF691 ceiling fan remote control kit utilizes 433.92MHz radio frequency control technology. It consists of a remote control and a rectangular shape receiver. It is designed for easy installation and operation.

- Good for all ceiling fans;
- Two load outputs, one for controlling the fan and another one for controlling the lights;
- Three fan speeds;
- ABS-V0 flame resistance material; and
- Elegant design and high quality build.

What Are Included?

AS-CF691 ceiling fan remote control kit consists of two pieces, as shown in Fig. 1.



Fig. 1 AS-CF691 Ceiling Fan Remote Control Kit

- An RF remote control unit with a wall mount bracket; and
- A rectangular shape receiver that can receive control commands from the remote control unit. This receiver uses existing wiring and can easily fit into the canopy of the ceiling fans.

Specification Parameters:

Input Voltage	220~240V/50Hz~60Hz	Operation Environment	No-condensation 20-90% RH, -20℃~55℃
Fan Wattage	150W	Light Wattage	600W
Battery for Remote Control	AAA batteries	Working Distance of Remote Control	12m
Remote Control Dimension	120mmx74mm	Receiver Dimension	120mm x 53mm x 23mm
Remote Control Weight	55g	Receiver Weight	105g

Wiring Diagram and Installation Guide:

AS-CF691 remote control unit is battery driven and there is no wiring requirement. The receiver has its all connection wires clearly labeled, as shown in Fig. 3.

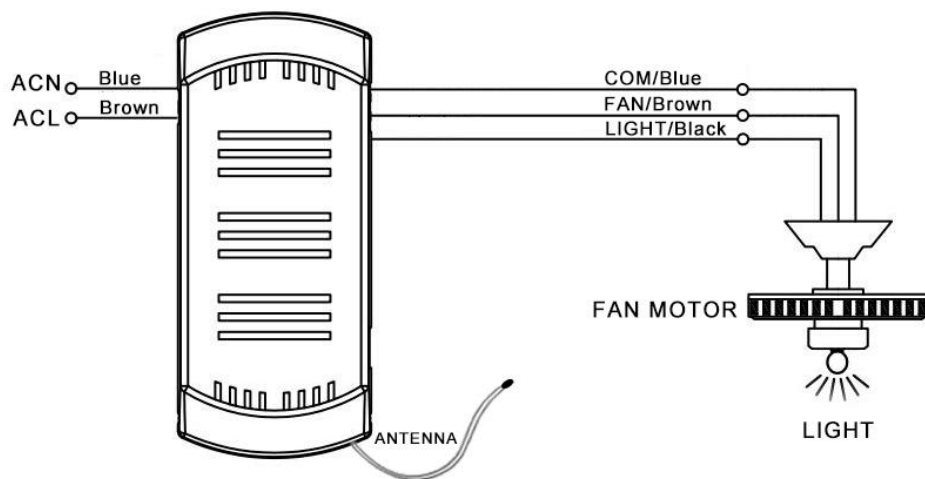

Fig. 3 AS-CF691 Receiver Wiring Diagram

ACL: Connected to the hot wire of power supply
 ACN: Connected to the neutral wire of power supply
 Light: Connected to the lights
 Motor: Connected to the fan
 COM: Connected to the neutral wire of the fan and/or lights
 Antenna: No connection

Warning: Please make sure power is turned off before starting installation!

Once properly wired, the AS-CF691 receiver can be installed into the canopy of the ceiling fan, as shown in Fig. 4.

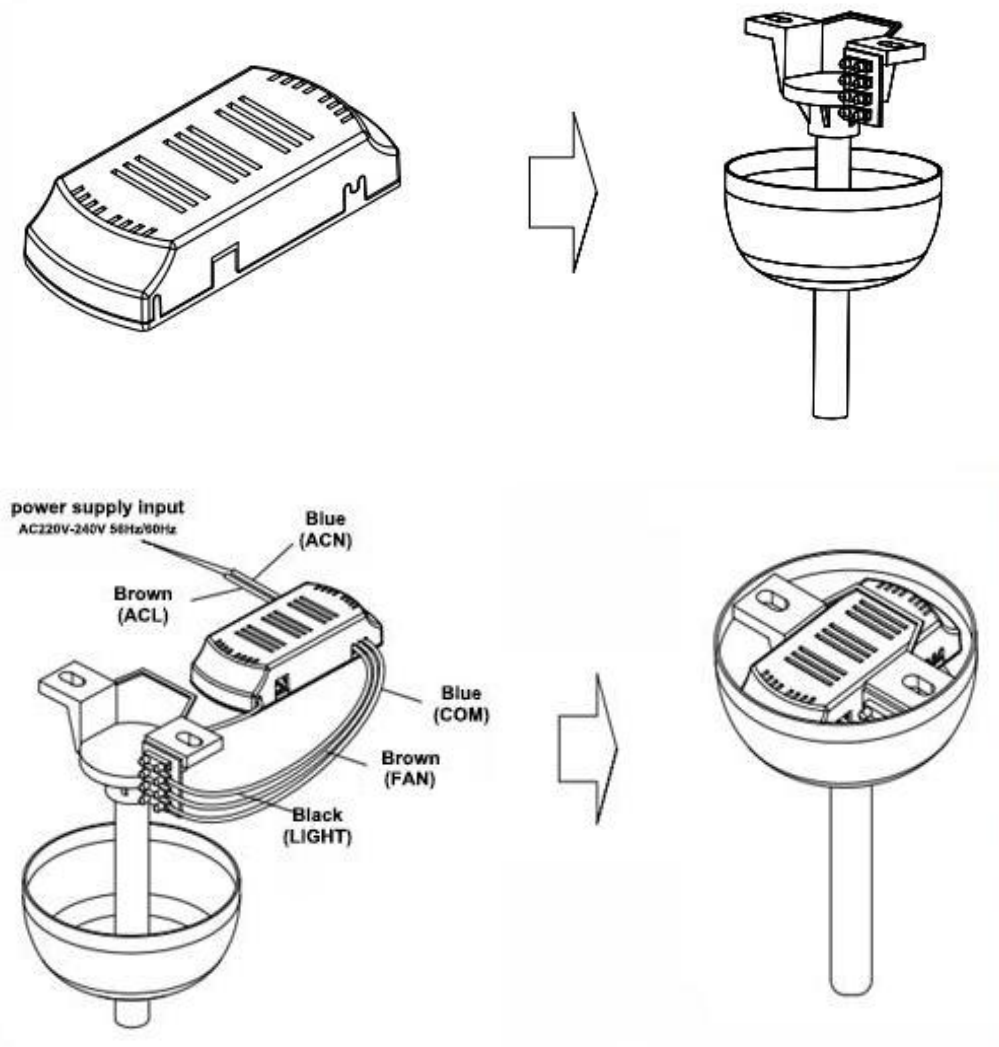

Fig. 4 AS-CF691 Receiver Installation

Setup and Operation Guide:

Fig. 5 shows the front and the back of the remote control unit. Before operating ceiling fan and lights, please complete the following two procedures:

- a. The remote control unit uses two AAA battery. Please open the sliding cover and install the battery.
- b. Turn on the power supply to the ceiling fan and lights. If there is another switch to control the fan speed and the lights, please set the switch to the highest fan speed and turn on the lights.

Now, it is ready to control the ceiling fan and lights using the remote control unit.

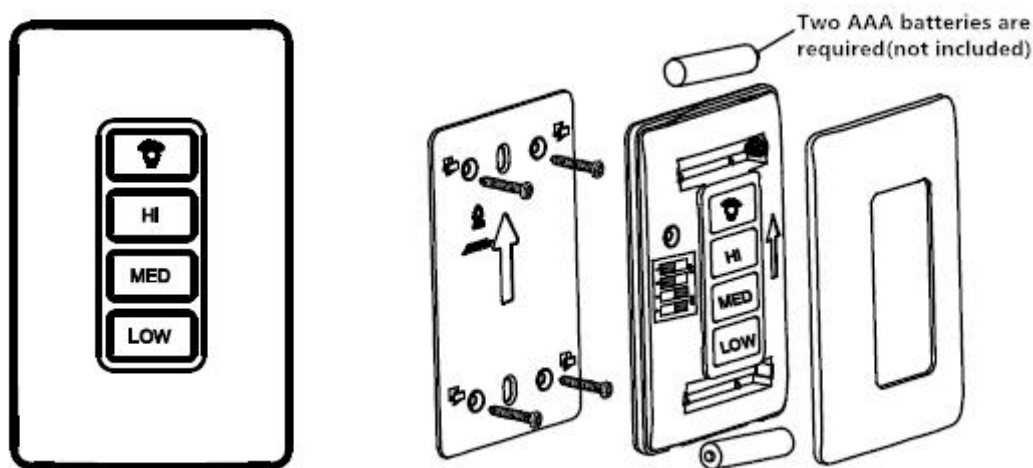

Fig. 5 AS-CF691 Remote Control Unit

1. **Turn on fan:** The remote control unit has three buttons LOW, MED, and HI. Pressing each of these three buttons will turn on the fan and set the fan to low speed, medium speed and high speed respectively.
2. **Turn off fan:** Long pressing either of the LOW/MED/HI button will turn off the fan.
3. **Turn on or turn off light:** Pressing the LIGHT button will turn on or turn off the lights.

Applications:

AS-CF691 ceiling fan remote control kit good is for all kind of ceiling fans, even for retrofitting an older ceiling fan. It can bring convenience and ease to our daily life and work.

They have wide applications at various locations such as homes, restaurants, conference rooms, theaters, etc.

How to Order:

Please contact us: Shenzhen Asia Bright Co., Ltd
Floor 2nd~3rd, Building E, North Area No.2 of Shangxue
Science Park, Bantian, Shenzhen, China
Tel: +86-755-89748200 +86-755-89748211
Email: sales@a-brt.com Website: www.a-brt.com