

## Product Descriptions

### Delay Off Timer Switch for One Load

**Model #:** BRT-119/119S

(Please visit our website [www.a-brt.com](http://www.a-brt.com) for more info)



#### **Features:**

BRT-119 is a delay off timer switch which is controlled by a micro controller unit and has countdown timing capability. Users can preset the delay-off time by pressing the corresponding time delay button: 10mins, 20mins, 30min, 60mins as desired. Loads will be turned off when the delay off time runs out. The timing task can be manually overridden by users at any time by pressing the power button in the central. BRT-119 is designed for easy installation and retrofit directly fit into standard wall box with no need for the neutral.

- Battery power supply
- Operates on two-wire system
- Good for all kinds of loads: LED lights, light strips, UV lights, exhaust fans, etc.
- ABS-V0 flame resistance material;
- Classical 86 series design and high quality build.

#### **Front View, Side View and Back View:**

Fig. 1 , Fig. 2 ,and Fig. 3 show the front view, side view, and the back view of the BRT-119 delay off timer switch respectively.

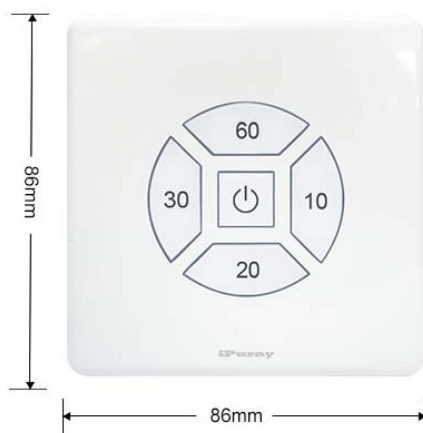

**Fig. 1** Front View

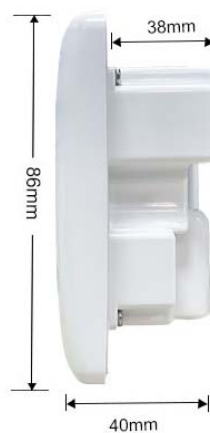

**Fig. 2** Side View



**Fig. 3** Back View

Central Button: Press the button in the center to turn on the load, press it again to turn the load off

- 10: press the button, the load is turned on and the time countdown starts, the LED of this button lights up, then blinks rapidly 8 times, then turn to slow blinking, the load is turn off after 10minutes runs out, and meanwhile the LED light off accordingly.

The same way to operate for the other 3 buttons 20,30,60.

When the battery is low: press any key, all LEDs flash twice, which indicates the battery is low, please replace the battery in time.

### Specification Parameters:

|               |   |                         |                    |
|---------------|---|-------------------------|--------------------|
| Power Supply  | 2pcs AAA batteries                                      | Battery Life            | 12 Months          |
| Input Voltage | 220V~240V 50Hz  | Load type               | All Types          |
| Wattage       | Resistive: 3000W<br>Inductive: 735W<br>Capacitive: 600W | Dimension               | 86mm x 86mm x 40mm |
| Model         |   | Delay Off Time          |                    |
| BRT-119       |   | 10min/20min/30min/60min |                    |
| BRT-119S      |   | 2min/5min/10min/15min   |                    |



### Wiring Diagram and Installation Guide:

BRT-119/119S delay off timer switch only requires hot wire for installation:

Hot wire (ACL): Coming from the power line with 220V;

Load wire: Going to the load.

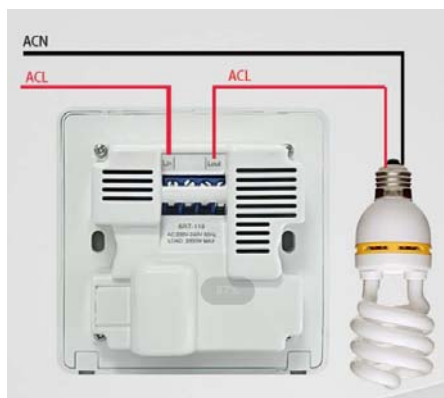

**Fig. 4** BRT-119/119S Delay Off Timer Switch Wiring Diagram

**Warning:** Please make sure power is turned off before starting installation!

Product Description of BRT-119/119s

Shenzhen Asia Bright Co., Ltd.

Floor 2<sup>nd</sup>~3<sup>rd</sup>, Building E, North Area No.2 of Shangxue Science Park, Bantian, Shenzhen, China

[www.a-brt.com](http://www.a-brt.com). [sales@a-brt.com](mailto:sales@a-brt.com).

© 2022 All rights reserved. Subject to change without notices.

Fig. 4 shows the wiring diagram and Fig. 5 shows the step-by-step installation instructions. There are four easy steps:

- Step one: Use a screwdriver to pry off the front plate;
- Step two: Wiring according to the diagram and the labelled ports of the switch; and
- Step three: Secure switch with screws.
- Step four: Install accessory 2pcs AAA battery as arrow pointed slot, and put the top cover on.

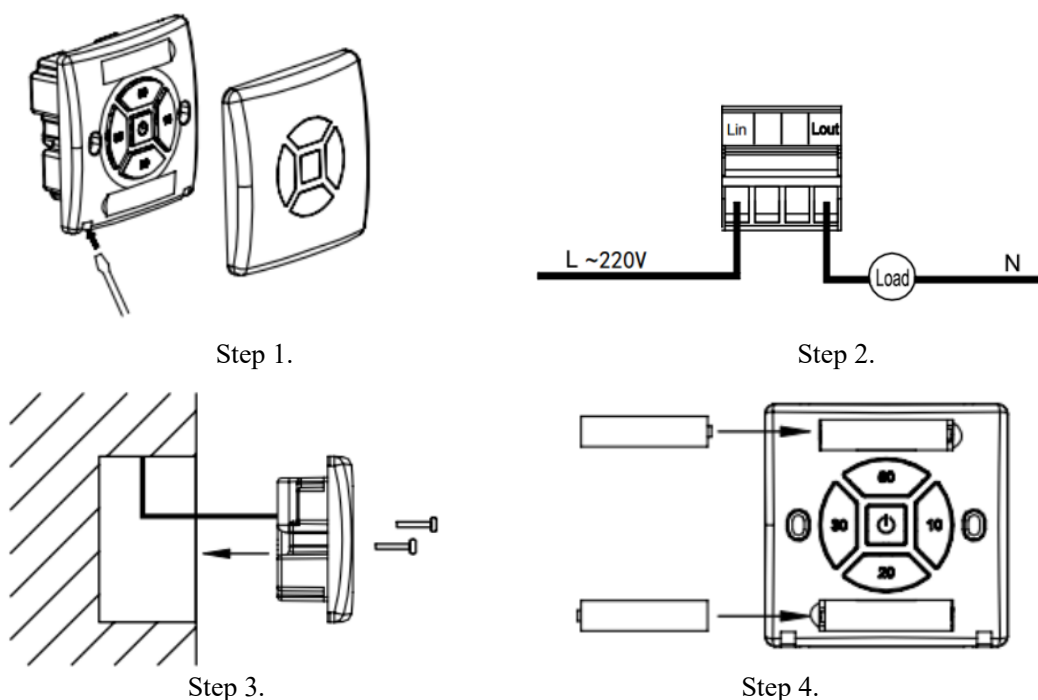

**Fig. 5** BRT-119/119S Timer Switch Installation Guide

### Applications:

BRT-119 delay off timer switch can be used for automatically turning off all kinds of loads such as fans, LED lights, light strips, UV lights, exhaust fans, pumps, appliances, or other kinds of electrical equipment. They are perfect for saving energy and bringing convenience and safety to our daily life and work.

The elegant design of BRT-119/119S timer switch makes it suitable for wide applications at various locations such as homes, bathroom, schools, laboratories, hospitals, offices, etc.

### How to Order:

Please contact us: Shenzhen Asia Bright Co., Ltd  
 Floor 2<sup>nd</sup>~3<sup>rd</sup>, Building E, North Area No.2 of Shangxue  
 Science Park, Bantian, Shenzhen, China  
 Tel: +86-755-89748200 89748211 89748345  
 Email: [sales@a-brt.com](mailto:sales@a-brt.com) Website: [www.a-brt.com](http://www.a-brt.com)

*Product Description of BRT-119/119s*

Shenzhen Asia Bright Co., Ltd.

Floor 2<sup>nd</sup>~3<sup>rd</sup>, Building E, North Area No.2 of Shangxue Science Park, Bantian, Shenzhen, China

[www.a-brt.com](http://www.a-brt.com). [sales@a-brt.com](mailto:sales@a-brt.com).

© 2022 All rights reserved. Subject to change without notices.